

1 2 3 4 5m

10

20

30

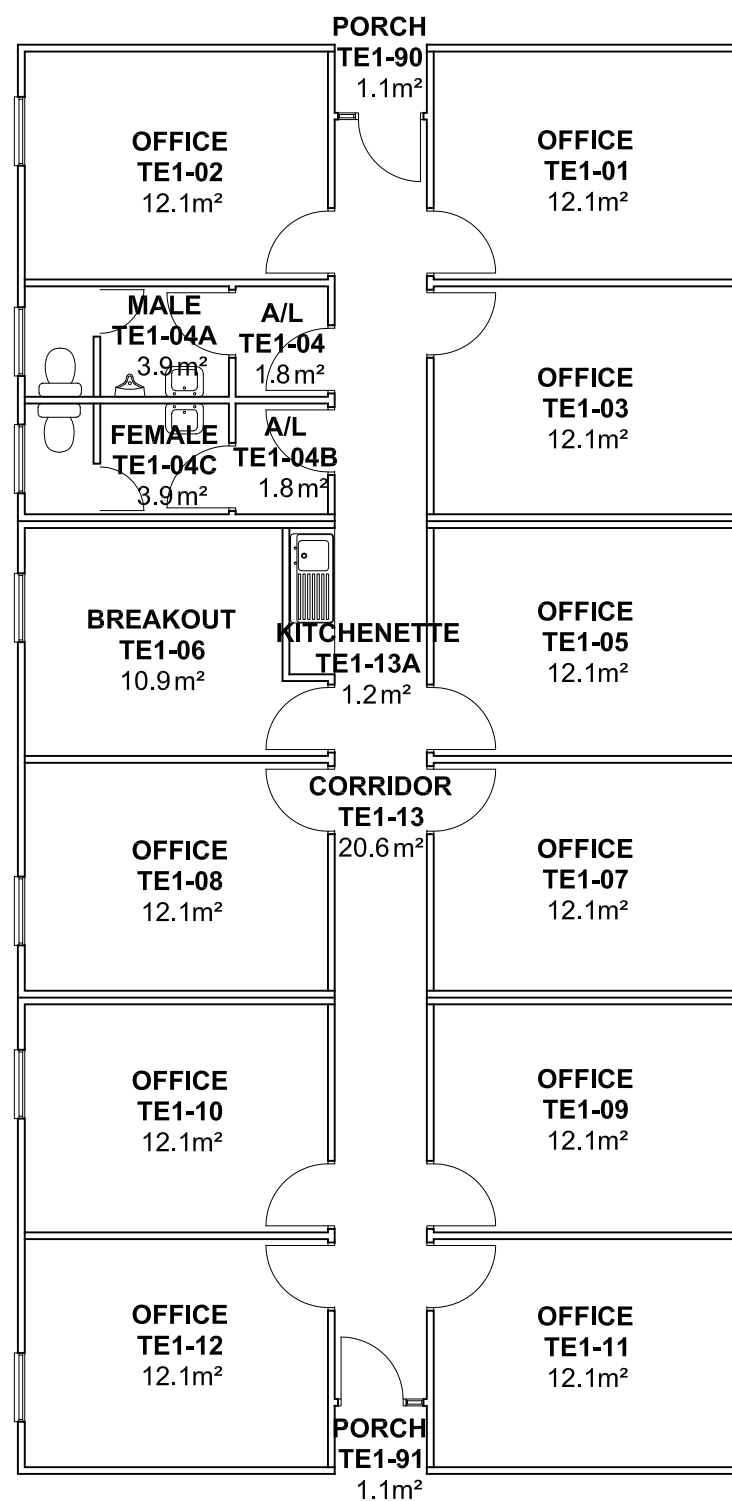

NOTES:
 Building Records drawings remain the property of the University of South Australia and must be returned upon request.
 These drawings may be inaccurate, and are subject to change without notice. Any errors and/or omissions should be reported to the Facilities Management Unit.



UNIVERSITY OF SOUTH AUSTRALIA

FACILITIES MANAGEMENT UNIT

101 Currie Street,
Adelaide, SA 5000

**BUILDING RECORDS
MAGILL CAMPUS**

Building

**BUILDING TE
LEVEL 1**

Scale: Refer to scale bar	Drawn: J Hvalica
Last Update: 07/09/2021	

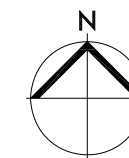

Drawing No.:	Revision:
A322PL01 - W	G