

2 4 6 8 10m 20 30 40 50 60 80 100

**NOTES:**  
Building Records drawings remain the property of the University of South Australia and must be returned upon request.  
These drawings may be inaccurate, and are subject to change without notice. Any errors and/or omissions should be reported to the Facilities Management Unit.

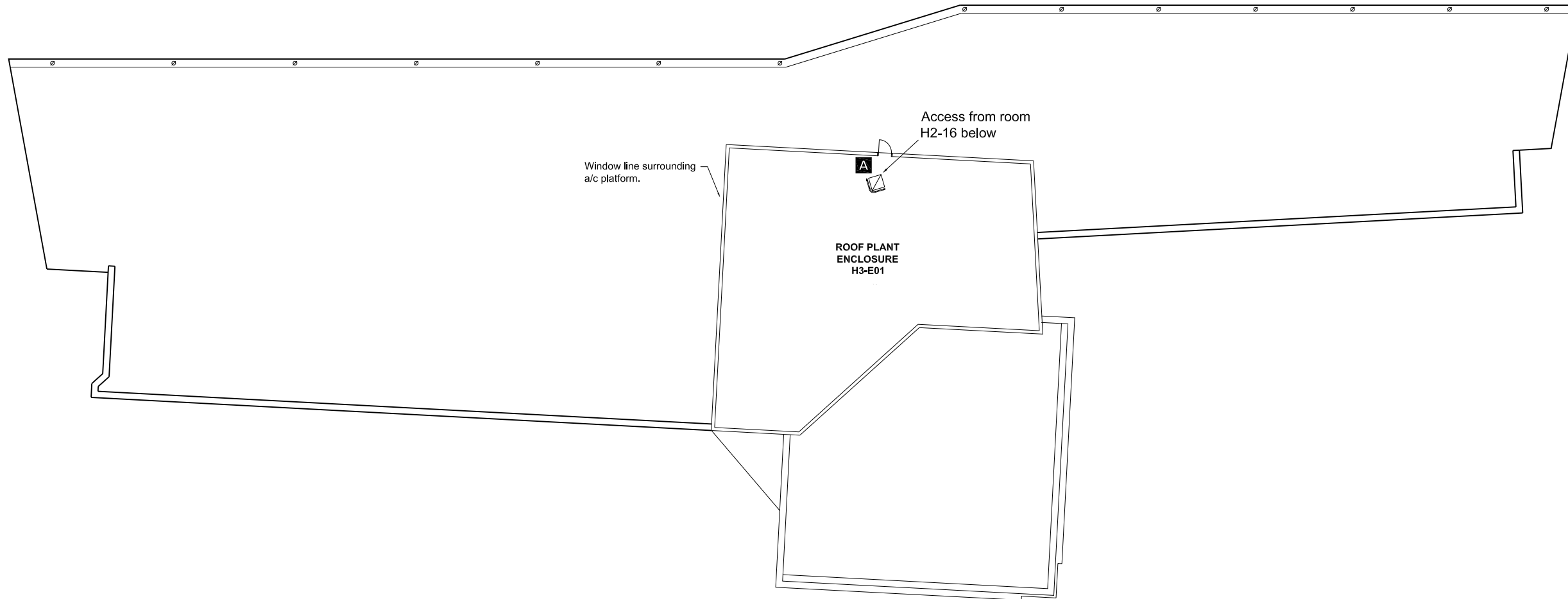

**UNIVERSITY OF SOUTH AUSTRALIA**

<b>FACILITIES MANAGEMENT UNIT</b>	Level 2, 101 Currie Street, Adelaide. SA 5000 Phone 8302 2762 Fax 8302 2708
---	---

**BUILDING RECORDS  
MAGILL CAMPUS**

Building  
**AMY WHEATON  
BUILDING H  
LEVEL 03**

Scale: Refer to scale bar	Drawn: J Hvalica
Last Update: 24/02/2016	

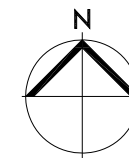

Drawing No.:	Revision:
<b>A348PL03 - W</b>	<b>C</b>