

1 2 3 4 5m 10 20 30

NOTES:
Building Records drawings remain the property of the University of South Australia and must be returned upon request.
These drawings may be inaccurate, and are subject to change without notice. Any errors and/or omissions should be reported to the Facilities Management Unit.

BUILDING SD

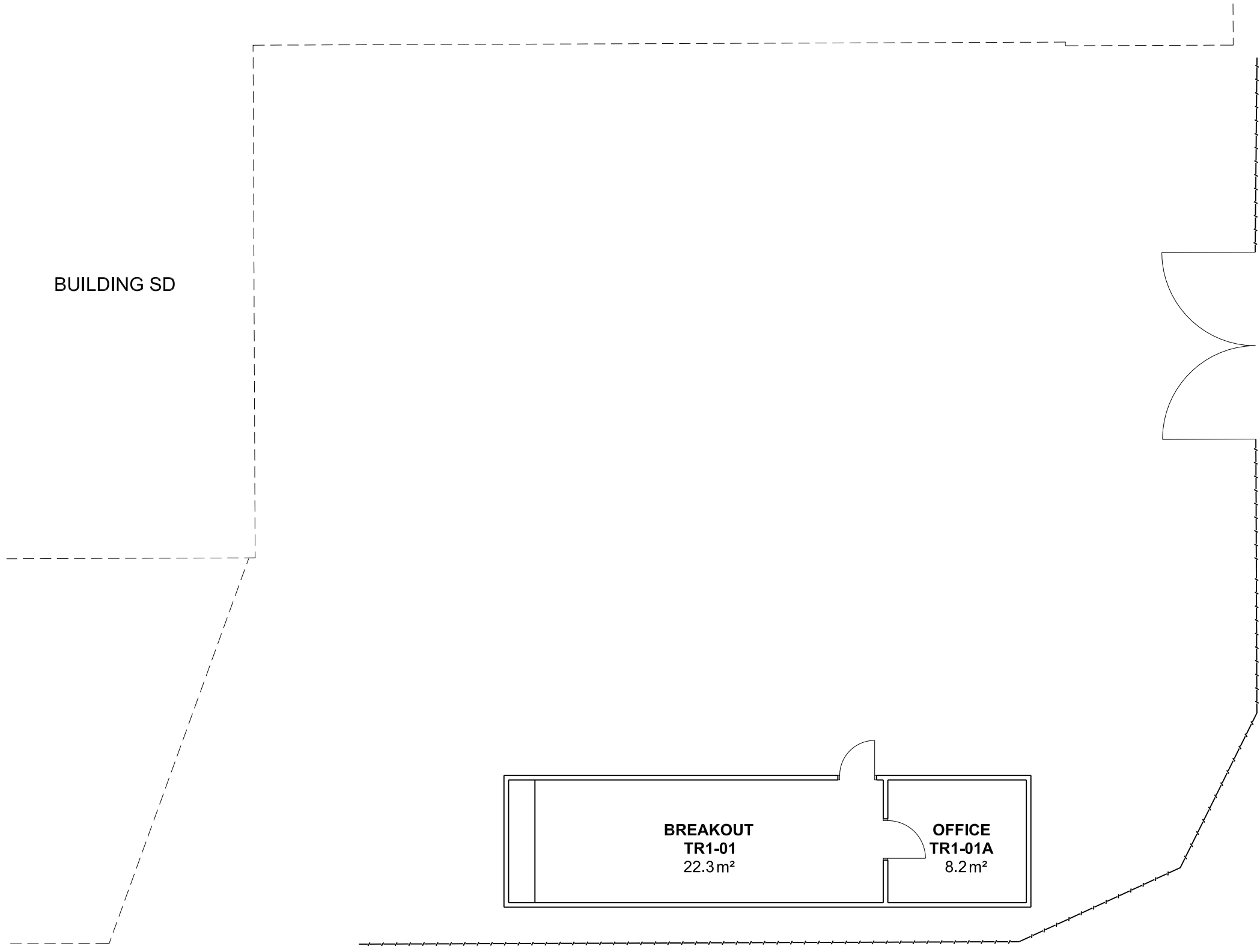

UNIVERSITY OF SOUTH AUSTRALIA

FACILITIES MANAGEMENT UNIT
Level 2,
101 Currie Street,
Adelaide, SA 5000
Phone 8302 2762
Fax 8302 2708

**BUILDING RECORDS
MAWSON LAKES CAMPUS**

Building
**TRANSPORTABLE
BUILDING TR (GROUNDS)
LEVEL 01**

Scale: Refer to scale bar
Last Update: 19/02/2015
Drawn: J Hvalica

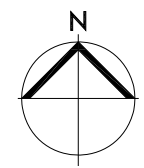

Drawing No.: **A563PL01 - W**
Revision: **B**