

1 2 3 4 5.0m 10 15

BUILDING AA

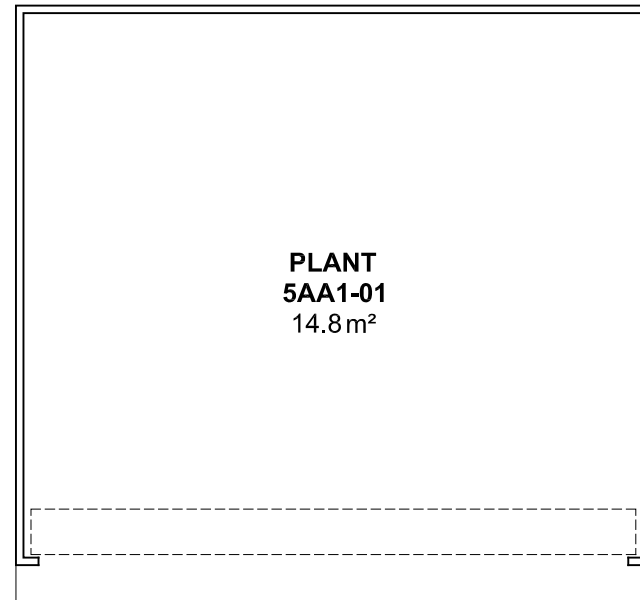
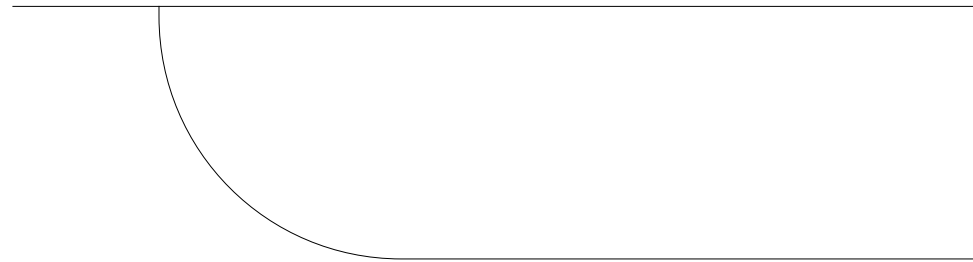

PLANT
5AA1-01
14.8m²

STEP

NOTES:
Building Records drawings remain the property of the University of South Australia and must be returned upon request.
These drawings may be inaccurate, and are subject to change without notice. Any errors and/or omissions should be reported to the Facilities Management Unit.



UNIVERSITY OF
SOUTH AUSTRALIA

**FACILITIES
MANAGEMENT
UNIT**
101 Currie Street,
Adelaide, SA 5000
Phone 8302 2762
Fax 8302 2708

**BUILDING RECORDS
MAWSON LAKES CAMPUS**

Building

**SHED 5AA
LEVEL 1**

Scale: Refer to scale bar
Drawn: J Hvalica

Last Update:
17/02/2017

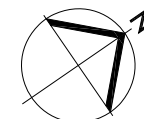

Drawing No.: **A5AAPL01 - W**
Revision: **A**