

2 4 6 8 10m 20 40 60

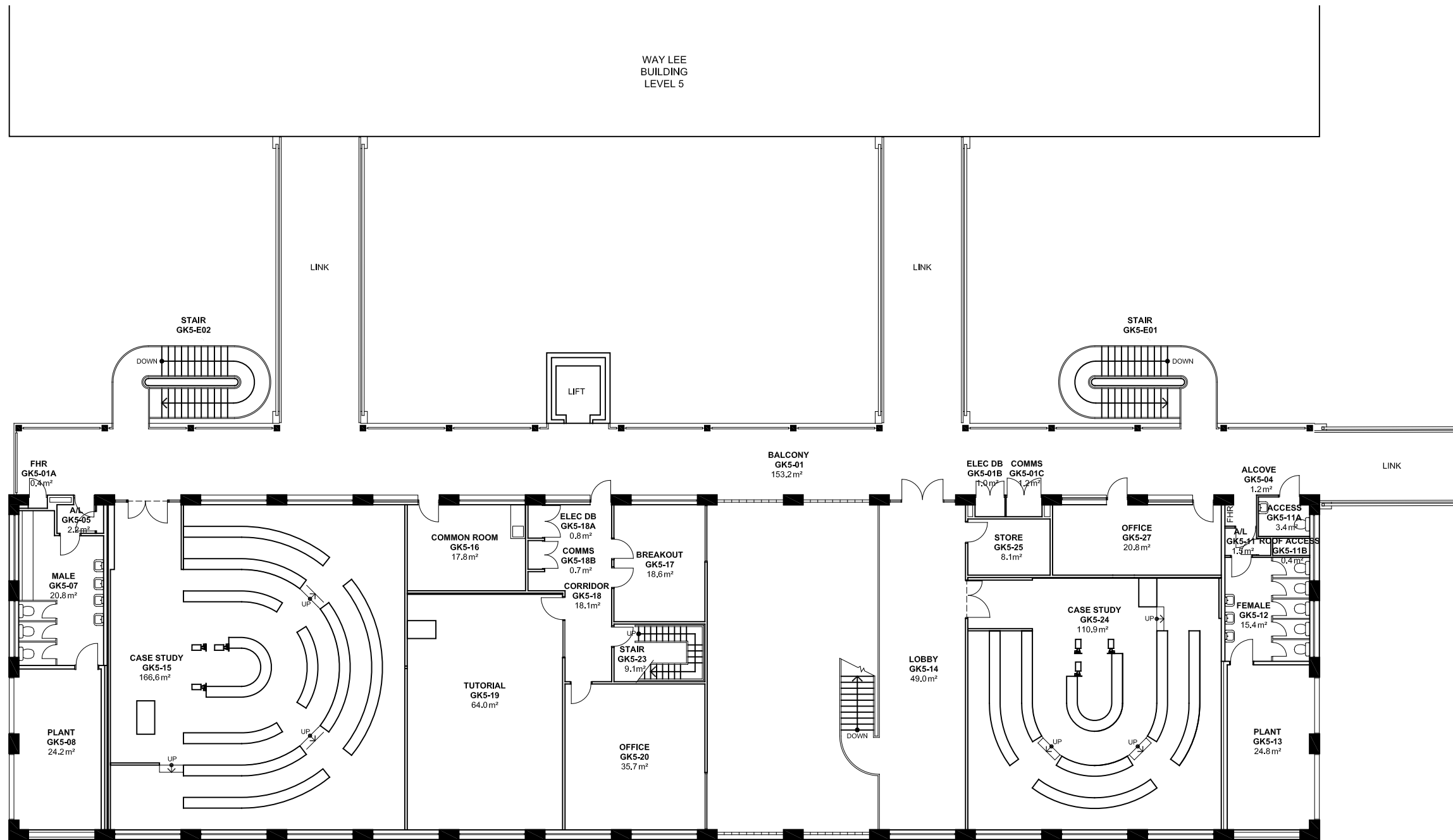

WAY LEE  
BUILDING  
LEVEL 5

LINK

LINK

STAIR  
GK5-E02

DOWN

LIFT

STAIR  
GK5-E01

DOWN

BALCONY  
GK5-01  
153.2m<sup>2</sup>

LINK

FHR  
GK5-01A  
0.2m<sup>2</sup>

A/L  
GK5-05  
2.6m<sup>2</sup>

MALE  
GK5-07  
20.8m<sup>2</sup>

CASE STUDY  
GK5-15  
166.6m<sup>2</sup>

PLANT  
GK5-08  
24.2m<sup>2</sup>

COMMON ROOM  
GK5-16  
17.8m<sup>2</sup>

TUTORIAL  
GK5-19  
64.0m<sup>2</sup>

ELEC DB  
GK5-18A  
0.8m<sup>2</sup>

COMMS  
GK5-18B  
0.7m<sup>2</sup>

CORRIDOR  
GK5-18  
18.1m<sup>2</sup>

BREAKOUT  
GK5-17  
18.6m<sup>2</sup>

STAIR  
GK5-23  
9.1m<sup>2</sup>

OFFICE  
GK5-20  
35.7m<sup>2</sup>

ELEC DB  
GK5-01B  
0.2m<sup>2</sup>

COMMS  
GK5-01C  
2.1m<sup>2</sup>

STORE  
GK5-25  
8.1m<sup>2</sup>

OFFICE  
GK5-27  
20.8m<sup>2</sup>

ALCOVE  
GK5-04  
1.2m<sup>2</sup>

ACCESS  
GK5-11A  
3.4m<sup>2</sup>

ROOF ACCESS  
GK5-11B  
1.3m<sup>2</sup>

ACCESS  
GK5-11B  
0.4m<sup>2</sup>

FEMALE  
GK5-12  
15.4m<sup>2</sup>

PLANT  
GK5-13  
24.8m<sup>2</sup>

**NOTES:**  
Building Records drawings remain the property of the University of South Australia and must be returned upon request.  
These drawings may be inaccurate, and are subject to change without notice. Any errors and/or omissions should be reported to the Facilities Management Unit.



UNIVERSITY OF  
SOUTH AUSTRALIA

**FACILITIES  
MANAGEMENT  
UNIT**  
101 Currie Street,  
Adelaide, SA 5000  
Phone 8302 2762  
Fax 8302 2708

**BUILDING RECORDS  
CITY WEST CAMPUS**

Building  
**SIR GEORGE KINGSTON  
BUILDING GK  
LEVEL 05**

Scale:  
Refer to scale bar  
Last Update:  
15/04/2016  
Drawn:  
J Hvalica

Drawing No.:  
**A706PL05 - W**  
Revision:  
**K**

